

# F8n Pro

## MultiTrack Field Recorder

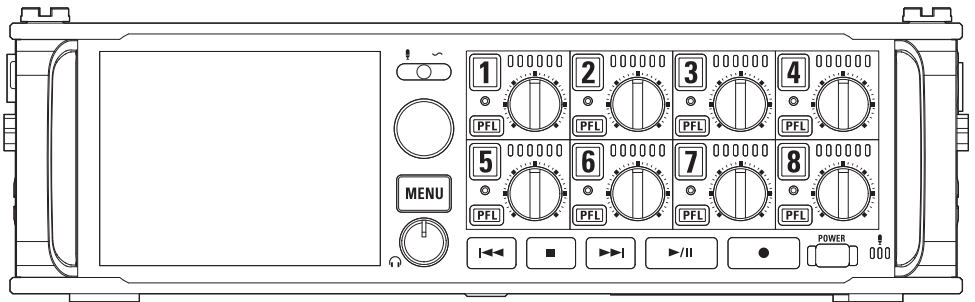

## Quick Tour

You must read the Usage and Safety Precautions before use.



The Operation Manual can be downloaded from the ZOOM website ([www.zoom.jp/docs/f8n\\_pro](http://www.zoom.jp/docs/f8n_pro)). This page has files in PDF and HTML formats.

The PDF file format is suitable for printing on paper and reading on a computer.

The HTML file format is suitable for smartphones and tablets and can be read with web browsers.

## Inserting SD cards

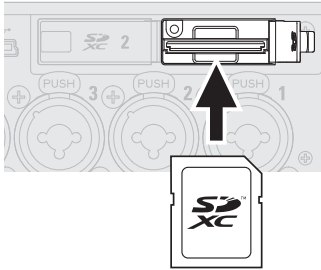

- Supported recording media: SDHC, SDXC cards
- To remove an SD card, push it further into the slot and then pull it out.
- Always turn the power off before inserting or removing an SD card.

## Preparing power sources

### ■ Using AA batteries

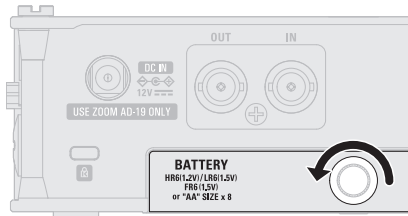

- Use only one type of battery (alkaline, NiMH or lithium) at a time.
- Set the type of battery used correctly so that the amount of remaining battery charge can be shown accurately.  
MENU>SYSTEM>Power Source  
Battery Type

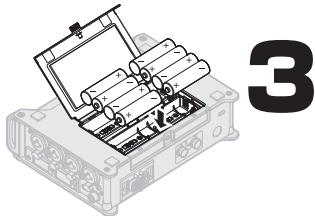
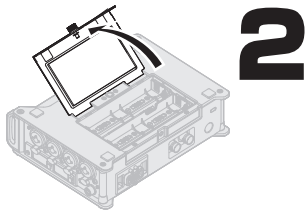

After loading the batteries, close the battery cover and tighten the screw.

## ■ Using external DC power supply equipment

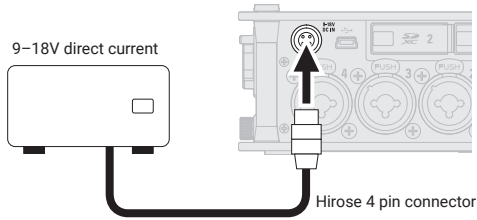

When connecting an external DC power supply, be sure to make the power supply settings.  
MENU>SYSTEM>Power Source  
Shutdown Voltage  
Nominal Voltage

## ■ Using an AC adapter

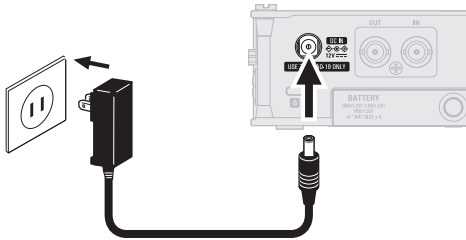

Dedicated AC adapter (ZOOM AD-19)

## Turning the power on

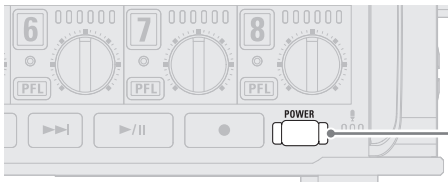

1 Press and hold to turn the power on.

The power will automatically turn off if the F8n Pro is unused for 10 hours.  
If you want to keep the power on always, turn off the automatic power saving (Auto Power Off) function.

# Setting the date and time

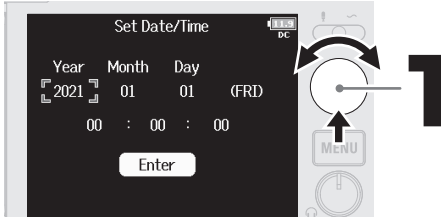

Turn to select setting items, and press to confirm them.

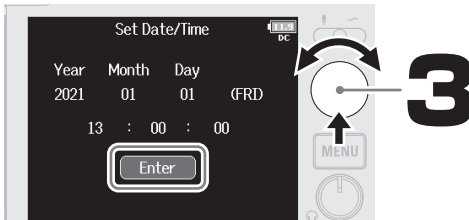
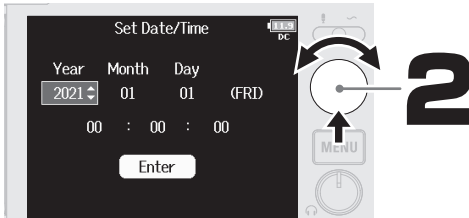

If power is not supplied by an AC adapter or batteries for a long time, date and time settings will be reset. If the date and time setting screen appears during startup, set them again.

## ■ Home Screen

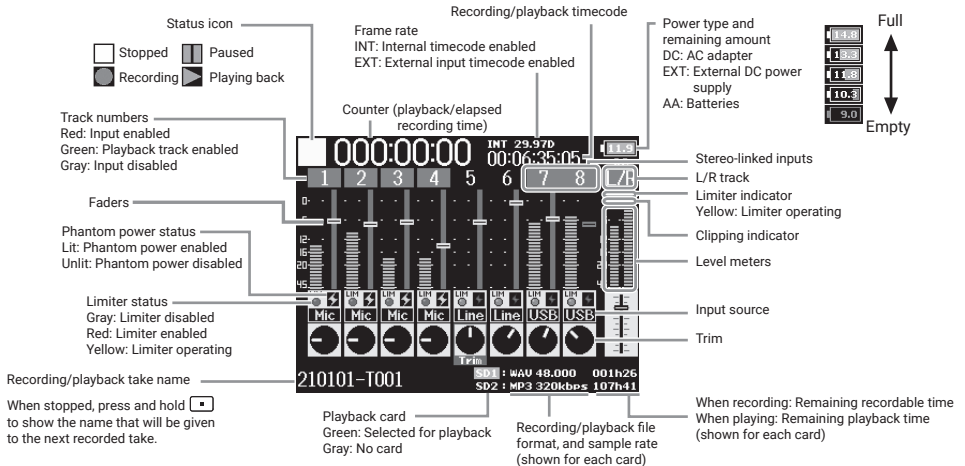

# Formatting SD cards

After purchasing a new SD card, always format it to maximize performance.

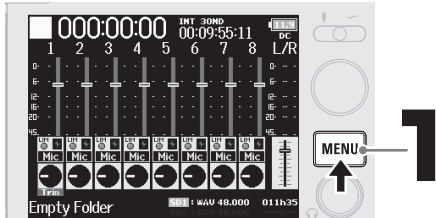

All data previously saved on an SD card will be deleted when it is formatted.

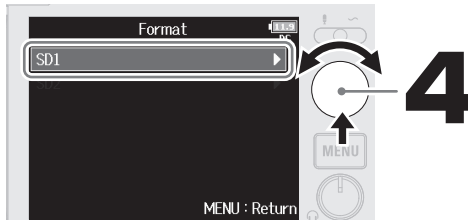
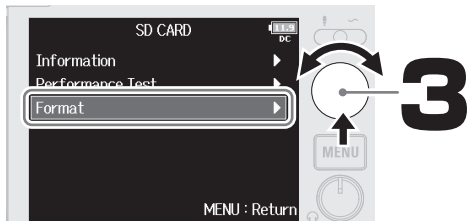
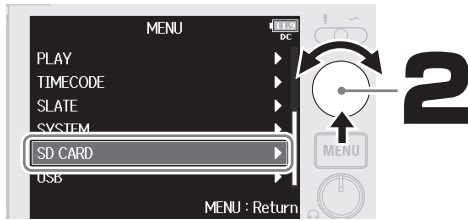

Select "SD1" after inserting an SD card.

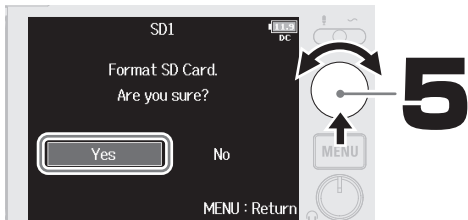

The Home Screen can be reopened by pressing and holding **MENU**.

## Connecting

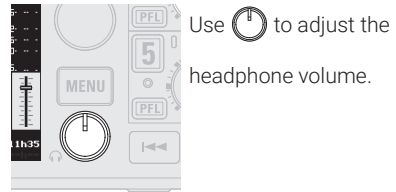
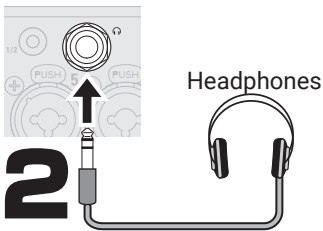
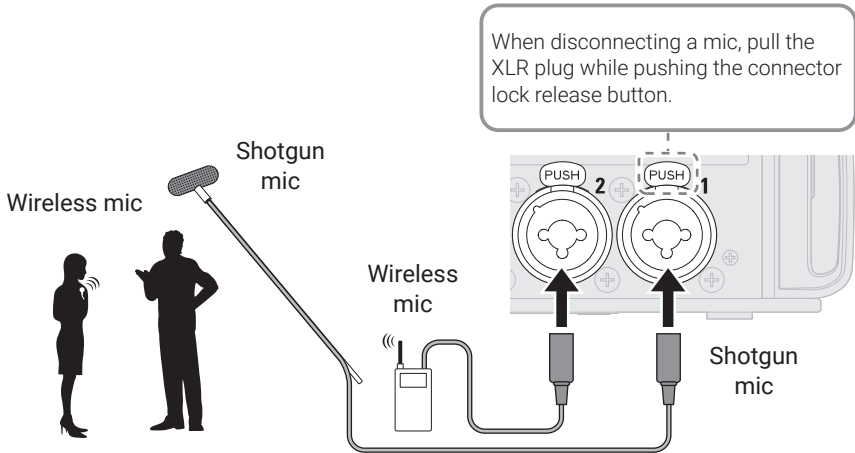

## Enabling tracks for recording

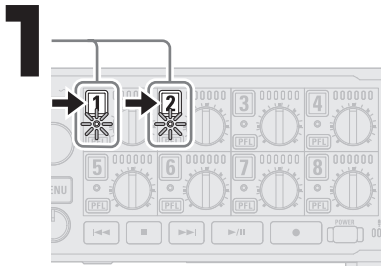

The status indicators will light red.

## Enabling phantom power

Do not use this function with devices that are not compatible with phantom power. Doing so could damage the device.

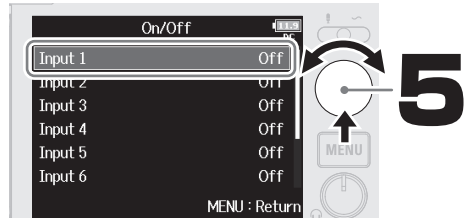
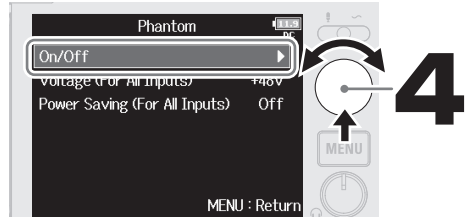
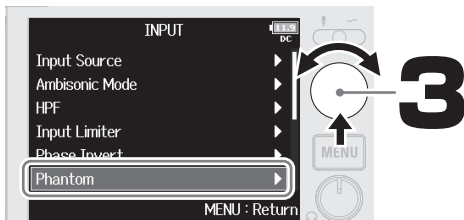
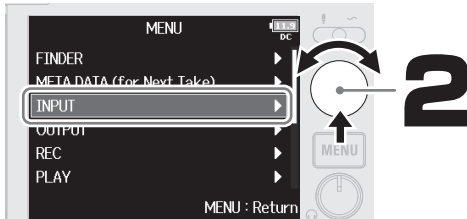
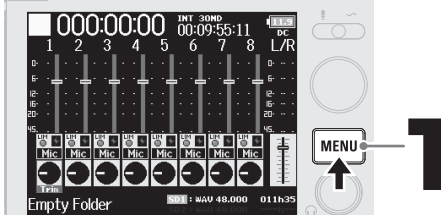

Select "Input 1" after connecting a condenser mic to it.

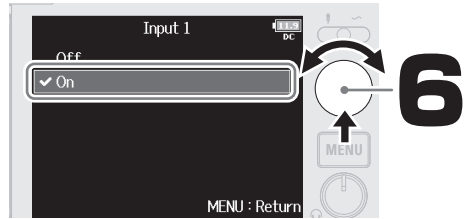

The Home Screen can be reopened by pressing and holding **MENU**.

## Adjusting input levels (trim)

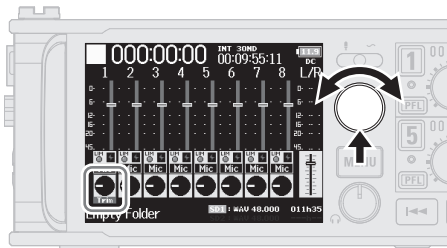

- Input volume (trim) settings do not affect the recording data.
- When recording in 32-bit float WAV format, if monitored audio sounds distorted, lowering the volume of the recording file can restore the waveform to a state without clipping.
- When recording in 16/24-bit WAV format, adjust so that the level meters are around  $-12$  dB at maximum volume.

## Using the faders to balance the mix

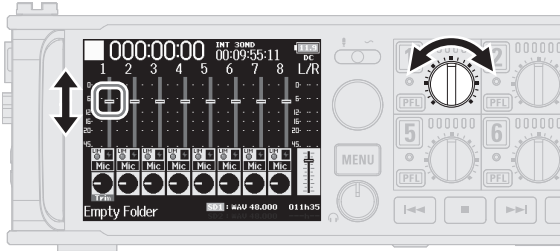

Adjust the balance to make monitoring easy. Fader settings have no effect on recorded data.

## Setting recording file scene names

The F8n Pro names and manages recording files with the following format. Scene names, scene numbers and take numbers are also written in the recording file metadata.

Scene001-T001.wav





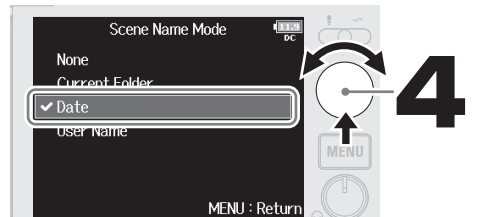
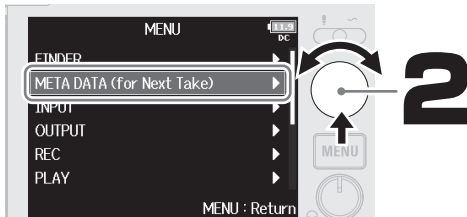
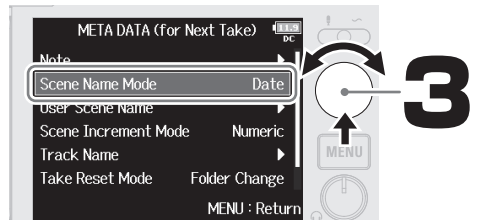
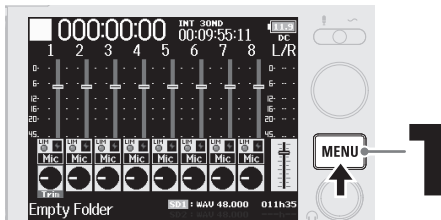

- Take number (increases by 1 every recording from 001–999)
- Scene number (can be advanced from 1–9999)
- Scene name (naming format can be set)



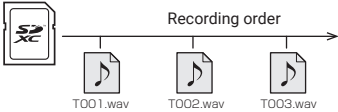

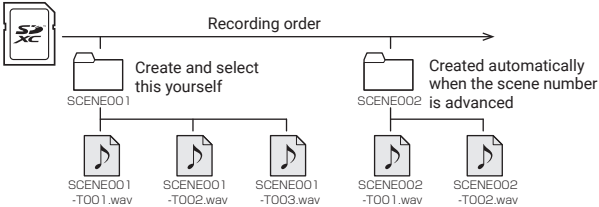
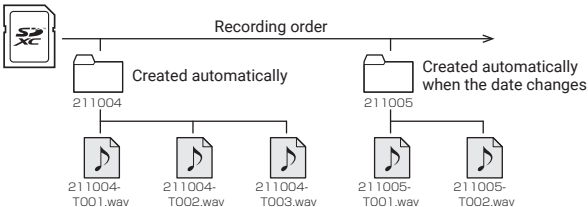
## Scene Name Mode

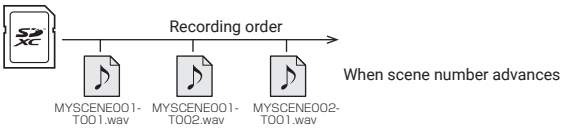
<p><b>None</b></p>	<p>The scene name and number are not used. When recording files are created, they are named only with take numbers, such as "T001", "T002", "T003" and so on.</p>
 <p>Files can also be created inside folders you have made.</p>	
<p><b>Current Folder</b></p>	<p>The name of the currently selected folder is used as the scene name. When recording is paused,  +  on the Home Screen can be pressed to advance the scene number by one. If no folder exists for the scene that was advanced by one, a new folder will be created.</p>
	
<p><b>Date</b></p>	<p>The current date is used as the scene name. If recording occurs after the date changes, a scene folder with the new date will be created.</p>
	
<p><b>User Name</b></p>	<p>A scene name input by the user is used. No folder will be created automatically. When recording is paused,  +  on the Home Screen can be pressed to advance the scene number by one.</p>
 <p>Files can also be created inside folders you have made.</p>	

# Receiving timecode

The F8n Pro supports SMPTE timecode (LTC).

The timecode of the recording start time is added to the metadata of the recording file.

Synchronize the timecode with cameras and other devices before beginning filming to make synchronization of recorded materials easy when editing later.

This section explains procedures for receiving timecode once before filming (synchronizing with timecode from a camera, for example), and then recording with the F8n Pro separate from the camera or other device.

## ■ Setting the frame rate

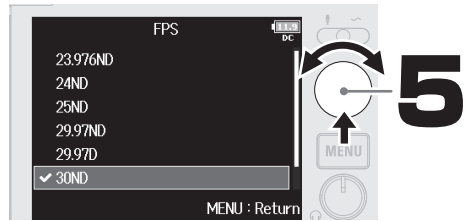
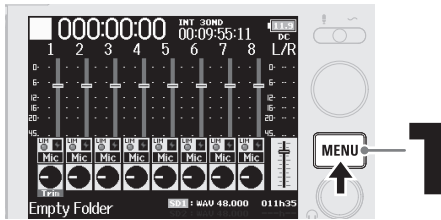

**MENU** can be pressed to return to the previous screen.

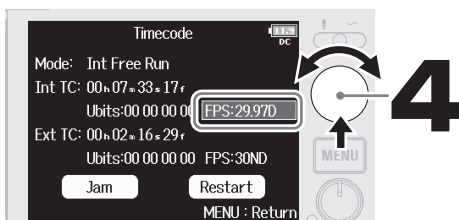
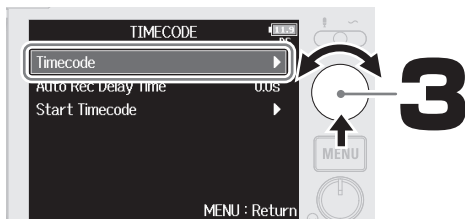
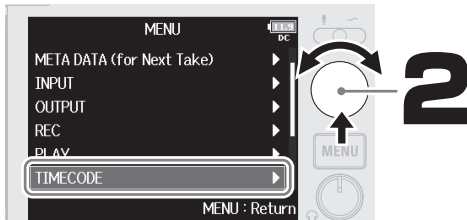

## ■ Connecting

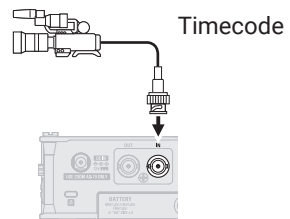



## ■ Synchronizing the timecode (jamming)



Disconnect the camera.

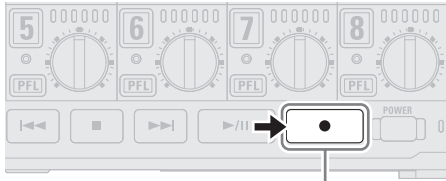



## Recording



Press  to stop recording.

**1**

### Shortcut operations (when recording paused)

Press and hold 	Show the name that will be given to the next take recorded. Example: Scene001-T002
 + 	Advance the scene number by 1 (when the Home Screen is open).
Press and hold 	Move the previously recorded take to the FALSE TAKE folder (when the Home Screen is open).

## Playing recordings

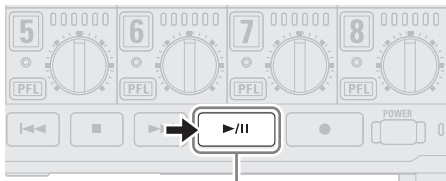

**1**

# Functions of parts

## ■ Front

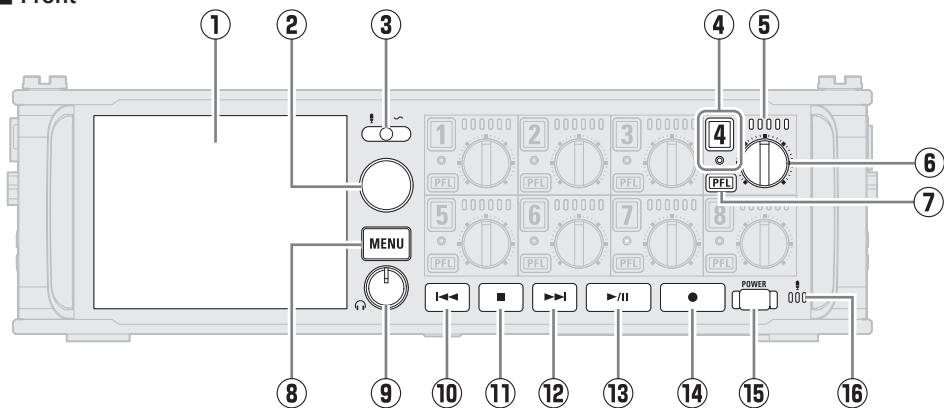

- ① **Display (LCD)**  
This shows the recorder status and MENU Screen.
- ② **Selection encoder**  
Use this to select and to confirm in various menus.
- ③ **Slate switch**  
Use this to record slate tones and with the slate mic.
- ④ **Track button/status indicator**  
Press the track button, lighting the status indicator red, to enable that track for recording.
- ⑤ **LED level meter**  
This lights according to the track input level.
- ⑥ **Track knob**  
This controls the track fader. Depending on the setting, this can also adjust trim or pan.
- ⑦ **PFL button**  
Press this to open the PFL Screen. The status indicator of the selected track will light orange.
- ⑧ **MENU button**  
Press this to open the MENU Screen or return to the previous screen.
- ⑨ **Headphone volume knob**  
This adjusts the headphone volume.
- ⑩ **REW button**  
Use this to search backward and to skip to the previous track.
- ⑪ **STOP button**  
This stops recording and playback.
- ⑫ **FF button**  
Use this to search forward and to skip to the next track.
- ⑬ **PLAY/PAUSE button**  
This starts and pauses track playback.
- ⑭ **REC button**  
This starts recording.
- ⑮ **Power button**  
This turns the power on/off.
- ⑯ **Slate mic**  
Use this for slate mic recording.

## ■ Back

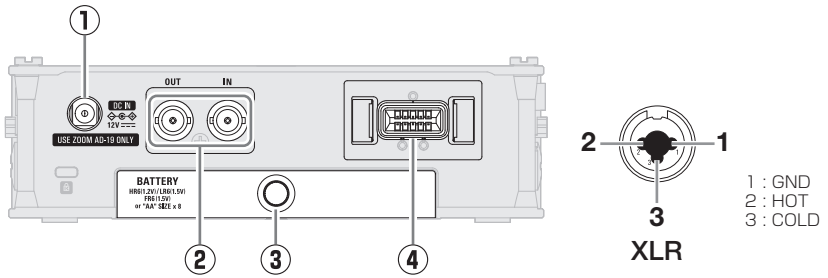

## ■ Left side

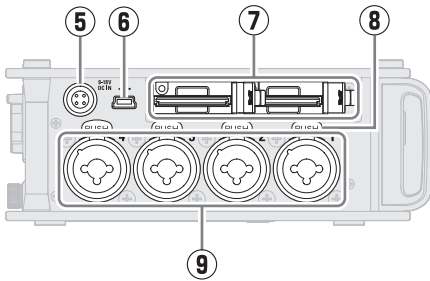

## ■ Right side

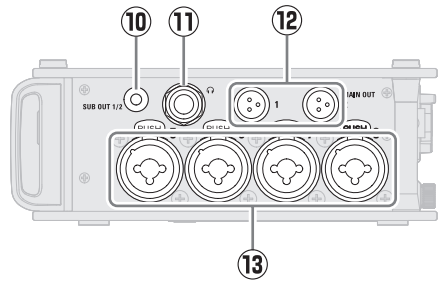

### ① 12 V DC IN

Connect the dedicated AC adapter (ZOOM AD-19) here.

### ② TIMECODE IN/OUT connectors

Use cables with BNC connectors to input and output timecode.

### ③ Battery cover

Open this when installing or removing AA batteries.

### ④ MIC IN connector

Mic capsules (sold separately) can be attached.

### ⑤ EXT DC IN connector

External DC power supplies that support Hirose 4-pin connectors can be connected here.

### ⑥ USB (Mini-B) port

Connect this to a computer, smartphone or tablet to use the F8n Pro as an SD card reader or audio interface. USB bus power operation is not supported.

### ⑦ SD card slots

Up to 2 SD cards can be loaded.

### ⑧ Lock release buttons

To disconnect a mic, pull the XLR plug while pressing this.

### ⑨ Inputs 1–4

Connect mics and instruments to these. These can be used with XLR and TRS connectors.

### ⑩ SUB OUT jack

This stereo mini jack (unbalanced) can be used to output sound.

### ⑪ Headphone jack

This can output sound to headphones.

### ⑫ MAIN OUT jacks

Use cables with TA3 connectors to output sound to speakers.

### ⑬ Inputs 5–8

Connect mics and instruments to these. These can be used with XLR and TRS connectors.

## Menu items

<b>FINDER</b>	View content lists of SD cards, takes and folders and to create folders. Set and delete recording/playback folders and to view their information, for example.
<b>META DATA (for Next Take)</b>	Various relevant data (metadata) can be written to files during recording.
<b>INPUT</b>	Make input settings.
<b>OUTPUT</b>	Make output settings, including for headphones.
<b>REC</b>	Make recording settings, including sample and bit rates.
<b>PLAY</b>	Make playback settings, including for playing all recordings and repeat playback.
<b>TIMECODE</b>	Make timecode input and output settings.
<b>SLATE</b>	Adjust the level of the slate mic/tone.
<b>SYSTEM</b>	Make F8n Pro system settings.
<b>SD CARD</b>	Check SD card data and format SD cards.
<b>USB</b>	Enable USB use, including as an SD card reader or audio interface.

## Input settings list

<b>Input Source</b>	Set this according to the connected device to “Mic”, “Line”, “USB 1”, “USB 2”, “USB 3” or “USB 4”.
<b>Ambisonic Mode</b>	By connecting mics that can output Ambisonic A-format signals to Inputs 1–4, audio can be converted to Ambisonic B-format and recorded.
<b>HPF</b>	The high pass filter can cut low frequencies to reduce the sound of wind, vocal pops and other noise.
<b>Input Limiter</b>	The limiter can prevent distortion by reducing signals that have excessively high levels.
<b>Phase Invert</b>	The phase of input signals can be inverted. This is useful when sounds cancel each other out due to mic settings.
<b>Phantom</b>	Phantom power settings can be made.
<b>Plugin Power</b>	Make this setting when a mic that is compatible with plug-in power is connected to the MIC/LINE input connector of a mic capsule.
<b>Input Delay</b>	If there are differences in the timing of input sounds, use this function to correct them when recording.
<b>Stereo Link Mode</b>	Mid-side mic signals can be set to be monitored as an ordinary stereo signal.
<b>Trim Link</b>	The input levels of multiple tracks can be linked and adjusted at the same time.
<b>PFL Mode</b>	On the PFL Screen, the monitoring sound can be set to be either pre-fader (PFL) or post-fader (SOLO).
<b>Auto Mix</b>	When recording multiple sounds, mic inputs can be adjusted automatically.

# Troubleshooting

## **There is no sound or output is very quiet**

- Check the headphone connection.
- Confirm that the headphone volume of the F8n Pro is not lowered.

## **Sound from a mic or connected equipment cannot be heard or is very quiet**

- Check the orientation of the mic or the volume settings of the connected equipment.
- Check the F8n Pro input level (trim) settings.
- Check the F8n Pro fader settings.
- Check the F8n Pro headphone volume.
- Check the F8n Pro phantom power settings.

## **Recording is not possible**

- Confirm that the status indicator is lit red.
- Confirm that the SD card has open space.
- Confirm that an SD card is loaded properly in a card slot.
- If "Card Protected!" appears on the display, the SD card write-protection is enabled. Slide the lock switch on the SD card to disable write-protection.

## **Not recognized by computer when connected**

- Confirm that the USB cable being used is not designed only to provide power.
- The operation mode must be set on the F8n Pro to allow the computer to recognize it.
- A driver is necessary for use as an audio interface with Windows. Download the driver from the ZOOM website ([zoomcorp.com](http://zoomcorp.com)).

Product names, registered trademarks and company names in this document are the property of their respective companies. Windows® is a trademark or registered trademark of Microsoft® Corporation. All trademarks and registered trademarks in this document are for identification purposes only and are not intended to infringe on the copyrights of their respective owners.



**ZOOM CORPORATION**

4-4-3 Kanda-surugadai, Chiyoda-ku, Tokyo 101-0062 Japan  
[zoomcorp.com](http://zoomcorp.com)