



F3 Control for iOS/iPadOS Version 1.0

F3 Control for Android Version 1.0

Operation Manual



© 2022 ZOOM CORPORATION

Copying or reprinting this manual in part or in whole without permission is prohibited.

Proper display is not possible on grayscale devices.

Contents

Introduction	3
Copyrights	3
Installing F3 Control	4
iOS/iPadOS device	4
Android device	4
Connecting with an F3.	5
Recording	6
Home/Recording Screen	6
Selecting inputs	6
Menu items related to recording.	7
Inputting characters	8
Changing the waveform display magnification.	9
Adjusting the headphone volume.	10
Adjusting the line output volume	11
Playing a test tone	12
Recording	13
Playing recordings.	14
Playback Screen	14
Playing recordings	15
Selecting files for playback	16
Managing files	17
Showing the contents of SD cards	17
Checking files	18
Making input settings	19
Making input settings.	19
Other functions	20
Setting the date and time.	20
Setting the date format	21
Viewing the F3 and F3 Control versions.	21

Introduction

F3 Control is a remote control application designed for the ZOOM F3 Field Recorder.

In addition to the fundamental operations of starting/stopping recording/playback and searching forward/backward, this app can be used to add marks and to set various parameters.

This manual does not explain operation of F3 unit itself. See the F3 Operation Manual for detailed information about all its functions.

Copyrights

iPadOS is a trademark or registered trademark of Apple Inc.

App Store is a service mark of Apple Inc.

iOS is a trademark or registered trademark of Cisco Systems, Inc. in the USA and other countries and is used under license.

Android™ and Google Play are trademarks or registered trademarks of Google LLC.

The Bluetooth® word mark and logo are registered trademarks of Bluetooth SIG, Inc., and these marks are used under license by ZOOM CORPORATION.

Product names, registered trademarks and company names in this document are the property of their respective companies. All trademarks and registered trademarks in this document are for identification purposes only and are not intended to infringe on the copyrights of their respective owners.

Recording from copyrighted sources, including CDs, records, tapes, live performances, video works and broadcasts, without permission of the copyright holder for any purpose other than personal use is prohibited by law. ZOOM CORPORATION will not assume any responsibility related to infringements of copyrights.

Installing F3 Control

● iOS/iPadOS device

- 1.** Open the App Store on the iOS/iPadOS device and search for “F3 Control”.
- 2.** Tap “GET” on the F3 Control screen.

This will install F3 Control on the device.



● Android device

- 1.** Open the Google Play Store on the Android device and search for “F3 Control”.
- 2.** Tap “INSTALL” on the F3 Control screen.

This will install F3 Control on the device.



Connecting with an F3

MEMO

- A separate ZOOM BTA-1 Bluetooth adapter must be installed in F3 to remotely control it from a smartphone/tablet. For details, see the operation manual.

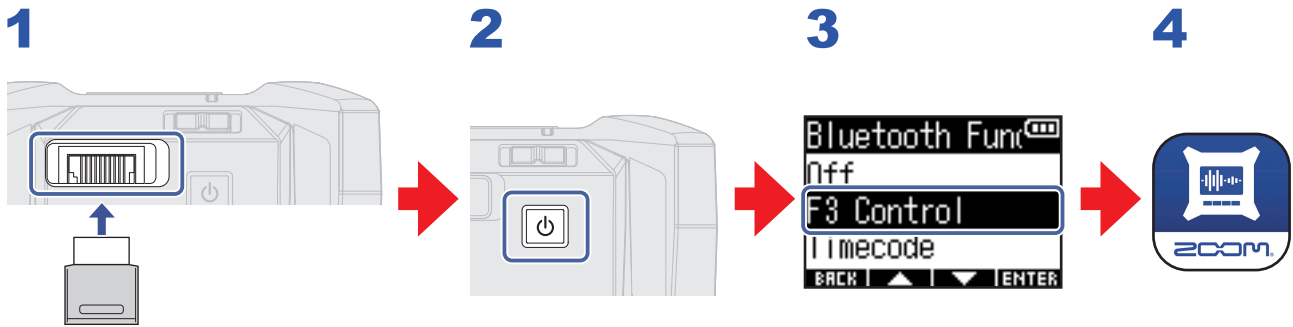

- 1.** Remove the F3 REMOTE connector cover and connect a BTA-1 or other dedicated wireless adapter.
- 2.** Start the F3.
- 3.** On the F3, press / to select "F3 Control" and press **ENTER**.
- 4.** Tap the F3 Control app icon on the smartphone/tablet.

This opens a Bluetooth device list in F3 Control.

Tap the device name/ID to start connecting.

When connection completes, "F3 Control Connected!" will appear on the F3 display.



MEMO

- If connection is not successful, move the device closer to the F3 or move both to a place where nothing interferes with radio waves and start F3 Control again. Confirm also that the Bluetooth function of the smartphone/tablet can be used.

Recording

Home/Recording Screen

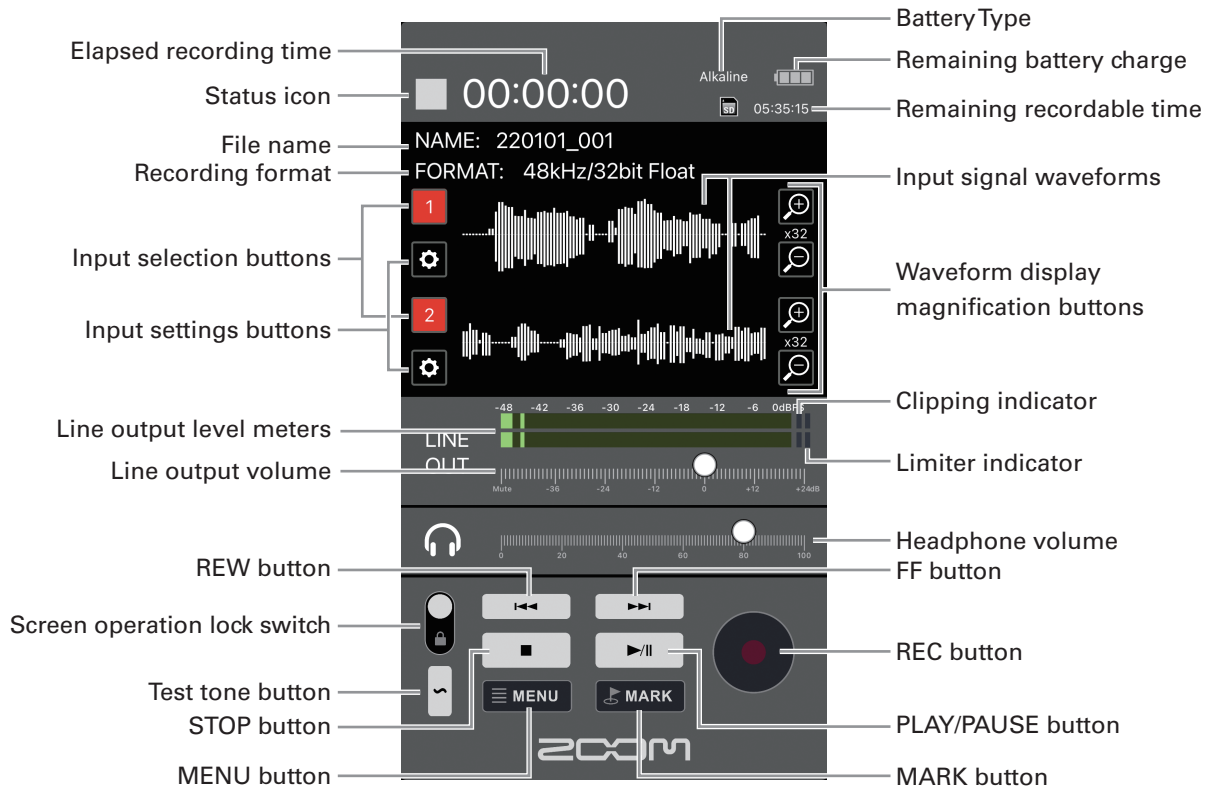

Screen operation lock switch settings

Setting	Description
	All screen operations are enabled.
	All operations are disabled except the screen operation lock switch.

Selecting inputs

Inputs can be selected for use.



1. Tap the input selection buttons on the HOME screen for the inputs to record.

Inputs that will be recorded appear red and inputs that will not be recorded appear black.

MEMO

- Waveforms for input signals that are not being recorded will not be shown on the Home Screen.

Menu items related to recording

Various settings related to recording can be made.

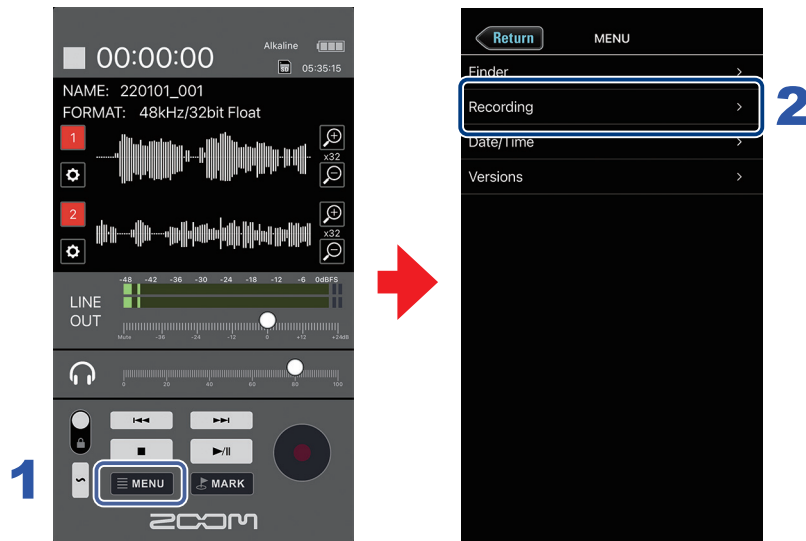

1. Tap **MENU** on the Home Screen.
2. Tap "Recording" on the MENU screen.
3. Tap an item on the Recording Screen to select it, and then change the setting.

Recording

Setting item	Description
Rec File Name	Set the recording file name format. (→ "Inputting characters" on page 8)
Sample Rate	Set the sampling rate used to record files.
File Format	Select mono or stereo for the WAV file recording format.
Pre Rec	Set the pre-recording function, which captures audio before recording starts, to On/Off.
Sound Marker	Turn on/off the sound marker function, which plays tone signals when recording starts.

Inputting characters

A character input screen will appear for inputting the User Defined Name used for the Rec File Name setting.

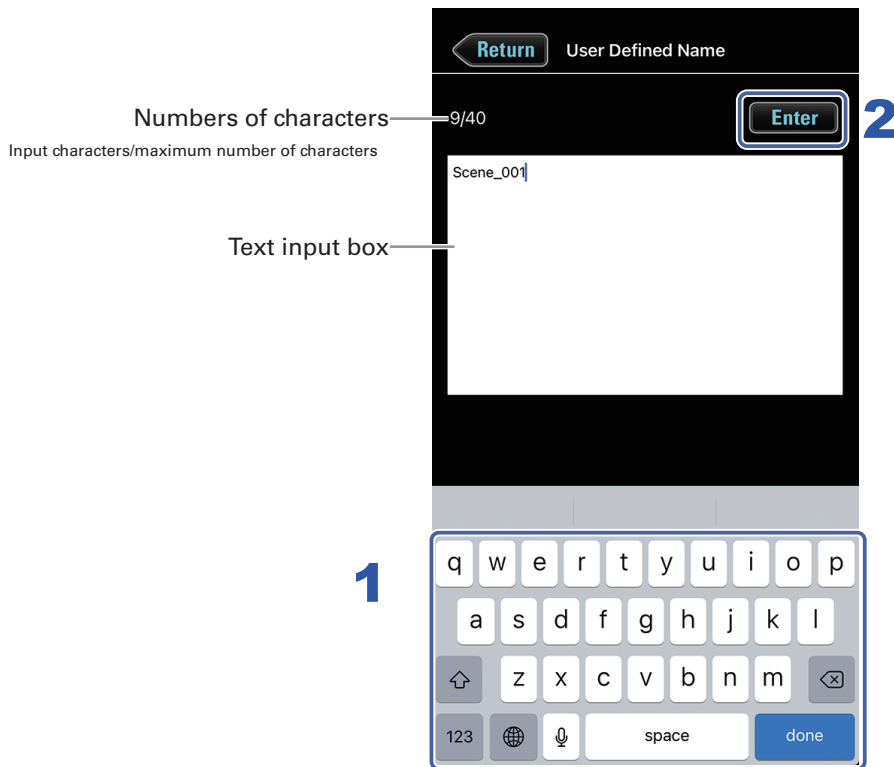

1. Input characters using the keyboard.

The input characters appear in the text box.

MEMO

- The following characters can be input.
(space)!# \$%&'()+,-0123456789;=@ABCDEFGHIJKLMNPOQRSTUVWXYZ[]^_`abcdefghijklmnopqrstuvwxyz{|}~
- You cannot put an @ mark or a space at the beginning.

2. When done inputting, tap **Enter** .

Confirm the input characters.

Tap **Return** to cancel the input.

Changing the waveform display magnification

1. On the Home Screen, tap a waveform display magnification button for the input to be changed.



Adjust the input signal waveform to a size that is easy to check.



Adjusting the headphone volume

The volume used for monitoring with headphones or another device can be adjusted.



1. Slide the HEADPHONE VOLUME on the Home Screen left and right to adjust the volume.

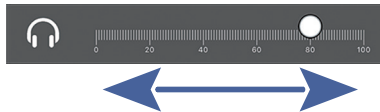

MEMO

- Double-tapping the Headphone volume will set it to 80.

Adjusting the line output volume

The line output volume to connected equipment can be adjusted.



1. Slide the LINE OUT volume control on the Home Screen left and right to adjust the level.

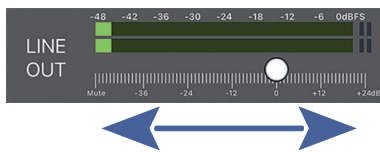

MEMO

- Double-tapping the Line output level will set it to 0db.

Playing a test tone

A test tone can be played in order to adjust the level of a connected device.



1. Touch on the Home Screen.

This starts output of the test tone.

Stop touching  to stop the test tone.



Recording



1. Tap on the Home Screen.

This starts recording.

Operations during recording

Function	Operation
Add a mark	Tap  . (During playback, you can jump to places where marks have been added.)
Stop	Tap  or  .

Playing recordings

Playback Screen

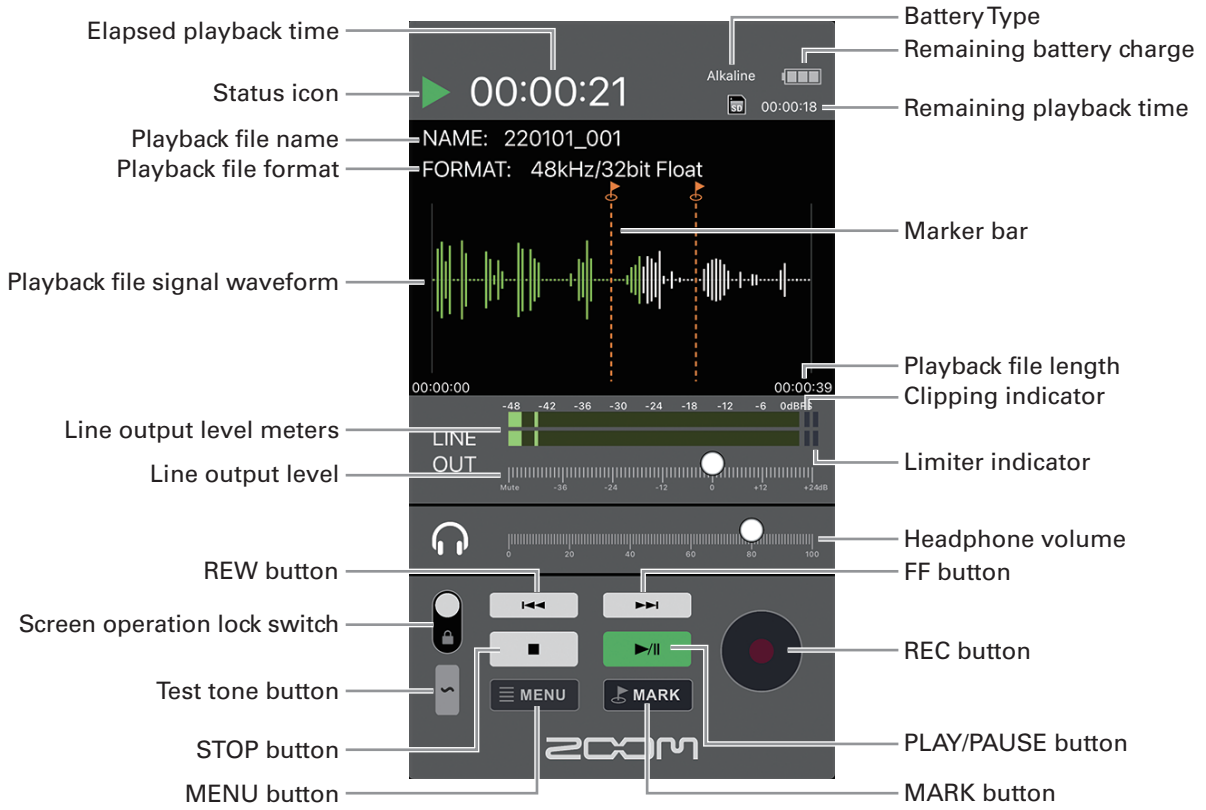









Playing recordings



1. Tap on the Home Screen.

This starts playback of the selected file.

Operations during playback

Function	Operation
Pause/resume	Tap  .
Search forward	Hold  .
Search backward	Hold  .
Move to the next mark (if one exists) Play the next file (if no mark exists)	Tap  .
Move to the previous mark (if one exists) Move to the beginning of the file (if no mark exists)	Tap  .
Play the previous file	Tap  at the beginning of a file.
Add a mark	Tap  MARK .
Stop	Tap  .

Selecting files for playback

Files can also be selected for playback on the Home Screen.



1. Tap  or  on the Home Screen.

This changes the playback file.

Managing files

Showing the contents of SD cards

Use the FINDER screen to check files on the SD card in the F3.

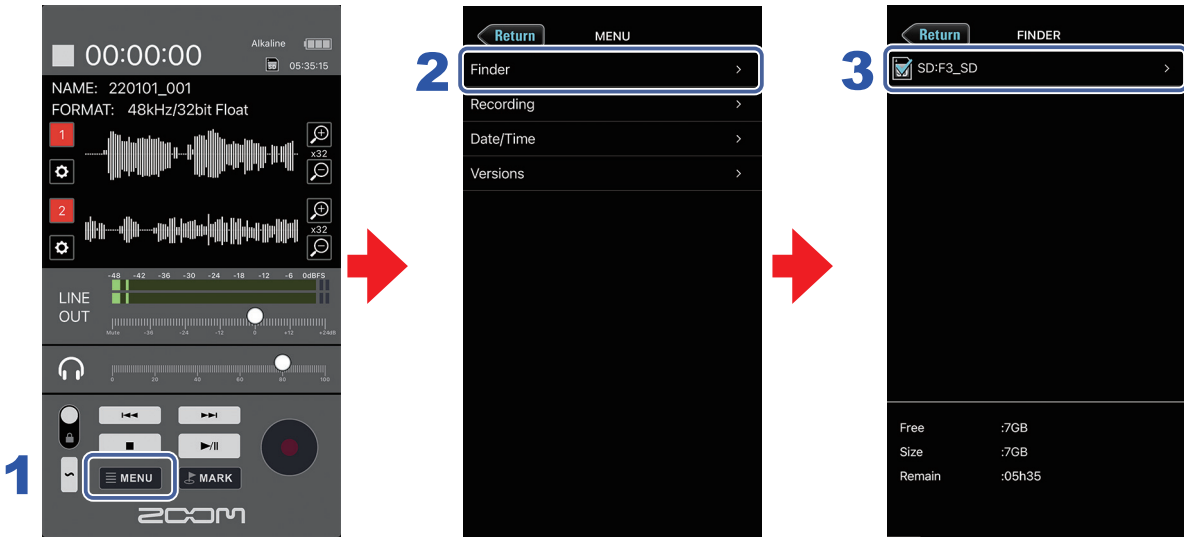

1. Tap **MENU** on the Home Screen.

2. Tap **Finder** on the Menu Screen.

MEMO

The following SD card information can be checked.

Data item	Description
Free	Open space
Size	Size
Remain	Remaining recordable time

Free	:7GB
Size	:7GB
Remain	:05h35

3. Tap **SD Card** on the **FINDER** screen.

This opens the File List Screen.



Checking files

Selected files can be played and their information can be checked.



1. Tap the file name.

This opens the Options Screen where you can check the following information.

Data item	Description
Path	File path
Length	Length of time
Format	Recording format
Date	Date created
Time	Time created

2. Tap Play on the Options Screen.

This starts file playback.

Making input settings

Making input settings

Input settings are made for inputs separately.

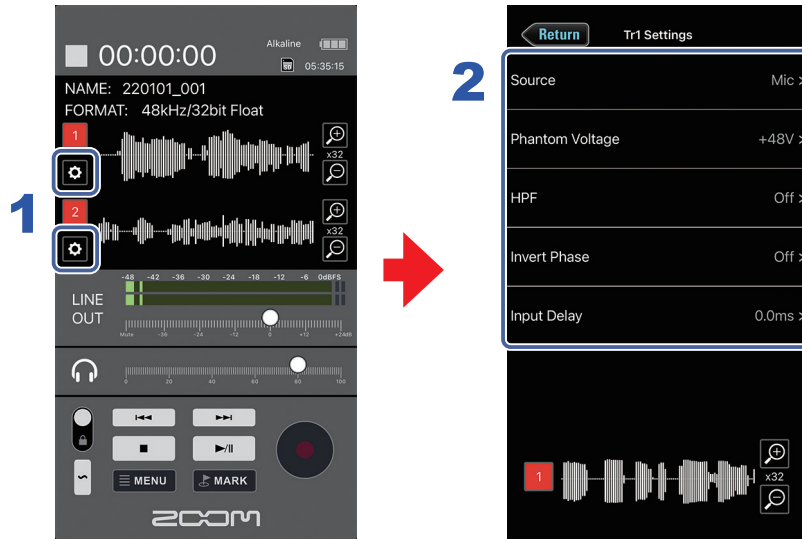

1. Tap  on the Home Screen for the input to set.

This opens the Input Settings Screen.

2. Tap a setting on the Input Settings Screen and change it.

Setting item	Description
Source	The input source and phantom power on/off status can be set for each track.
Phantom Voltage	The voltage of the phantom power can be changed. The selected voltage setting will be applied to both Input 1 and Input 2.
HPF	The high pass filter can cut low frequencies to reduce the sound of wind, vocal pops and other noise.
Invert Phase	The phase of input signals can be inverted. This is useful when sounds cancel each other out due to mic settings.
Input Delay	If there are differences in the timing of input sounds, use this function to correct them when recording.

Other functions

Setting the date and time

The F3 date and time can be set.



1. Tap **MENU** on the HOME screen.
2. Tap **Date/Time** on the Menu Screen.
3. Tap **Set Date/Time** on the Date/Time Screen.
4. Tap **OK** on the confirmation pop-up.

This sets the date and time of the F3.

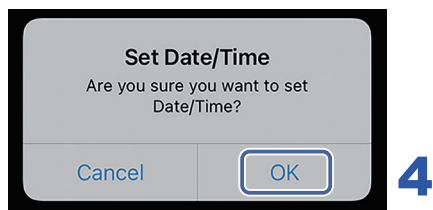

Setting the date format

The date format added to recording files can be changed.

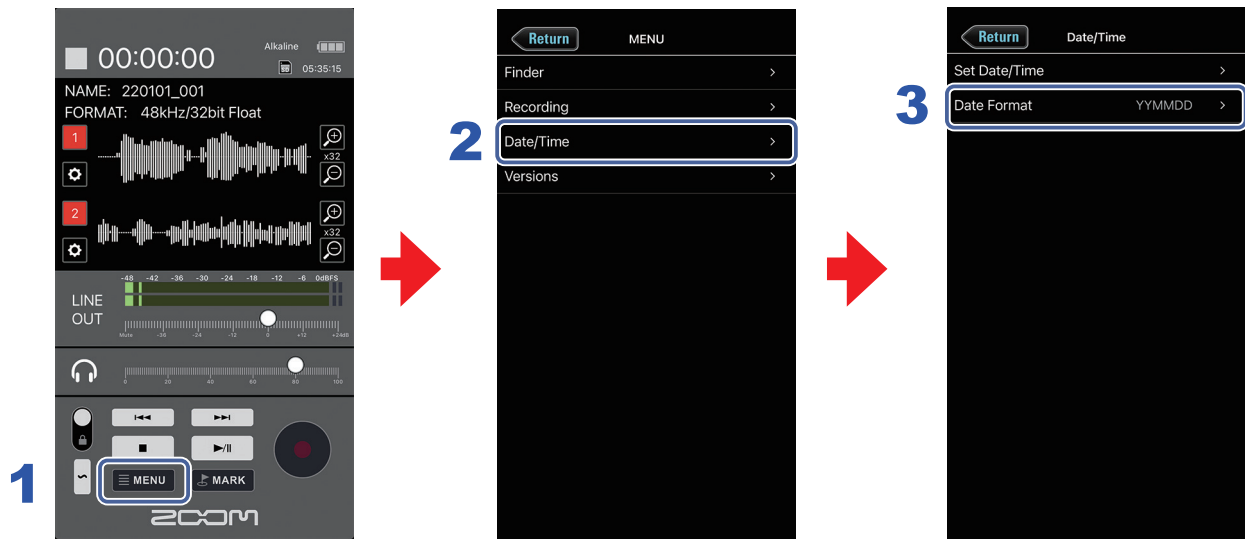

1. Tap **MENU** on the HOME screen.
2. Tap Date/Time on the Menu Screen.
3. Tap Date Format on the Date/Time Screen, and then change the setting.

Setting	Explanation
YYMMDD	Year, month, day order
MMDDYY	Month, day, year order
DDMMYY	Day, month, year order

Viewing the F3 and F3 Control versions

You can check the F3 and F3 Control versions.

1. Tap **MENU** on the HOME screen.
2. Tap Versions on the MENU screen.



ZOOM CORPORATION

4-4-3 Kanda-surugadai, Chiyoda-ku, Tokyo 101-0062 Japan
zoomcorp.com

Z2I-4499-02